

2 people are required for the installation.

This shower absolutely needs 3 walls surrounding it.

The rail wall brackets screws must be installed in wall studs to support the weight of the doors.

Dimensions

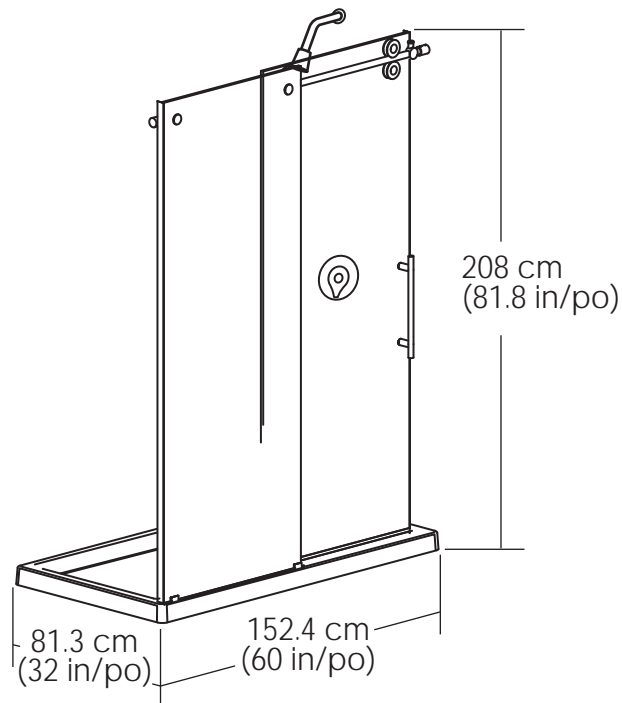

IMPORTANT NOTE

The glass door can be installed on the left or right side.

Artika recommends installing the glass door adjacent to the shower faucet wall.

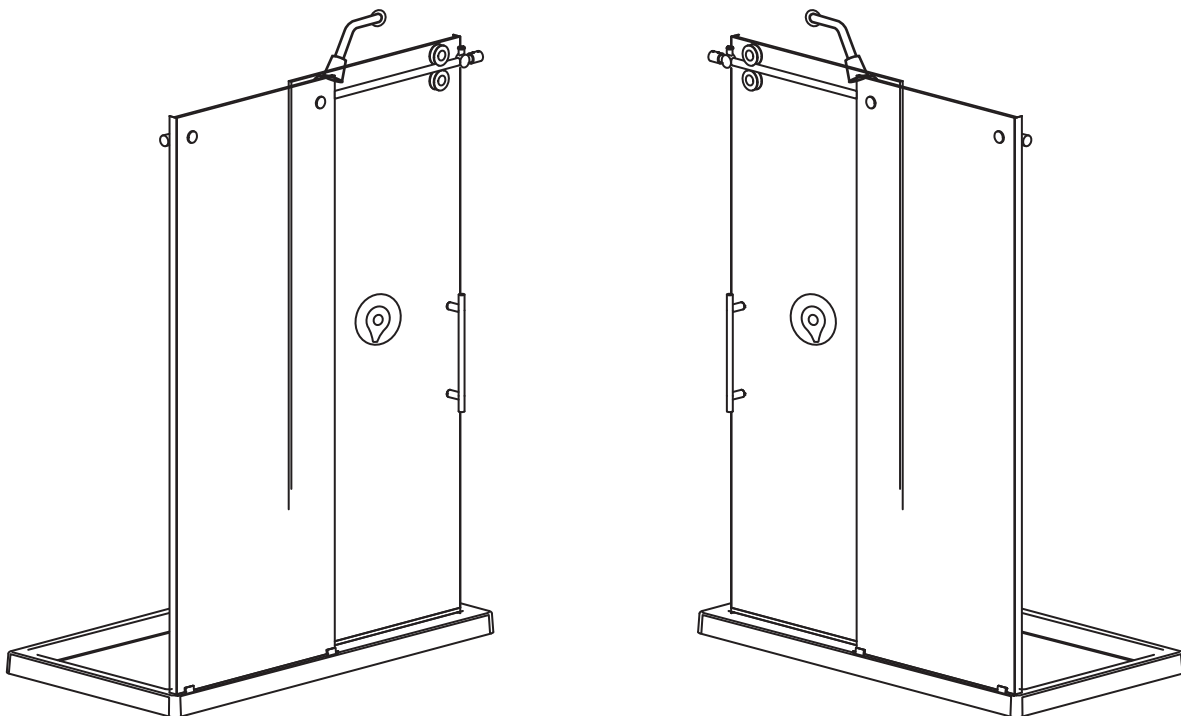

This instruction manual is showing a right side installation. For a left side installation, follow the instructions as though the sliding door was on the left.

You will need

- Screwdrivers
- Drill
- Drill bits 1/4 in. & 1/8 in.
(specific drill bit may be required for ceramic tiles)
- Silicone
- Tape measure
- Pencil
- Level
- If needed: cutting pliers

Hardware list (included)

- 3 Allen keys
- 2 regular screws
- 4 wall screws
- 14 Self-drilling 1 inch screws
- 14 Self-drilling 1,25 inch screws

Parts List

Item	Description	Artika Part #	Quantity
A	Base	999-359/P1	1
B	Fixed glass panel	999-359/P2	1
C	Sliding door panel	999-359/P3	1
D	Rail	999-359/P4	1
E	Stoppers	999-359/P5	2
F	Wall brackets	999-359/P6	2
G	Rail brackets	999-359/P7	2
H	Double bottom bracket	999-359/P8	1
I	Single bottom bracket	999-359/P9	1
J	Door panel gasket	999-359/P10	2*
K	Vertical gaskets	999-359/P11	3*
L	Wheels	999-359/P12	4
M	Fixed panel bracket	999-359/P13	2
N	Handle	999-359/P14	1
O	Bottom door gasket	999-359/P15	1
P	Bottom panel gasket	999-359/P16	2
Q	Threshold	999-359/P17	1
R	60 inch (152.4 cm) tiling flange	999-359/P18	1
S	32 inch (81.3 cm) tiling flange	999-359/P19	2
T	Drain	999-359/P20	1

*NOTE: Extra gaskets are included. Only one J gasket and two K gaskets are necessary.

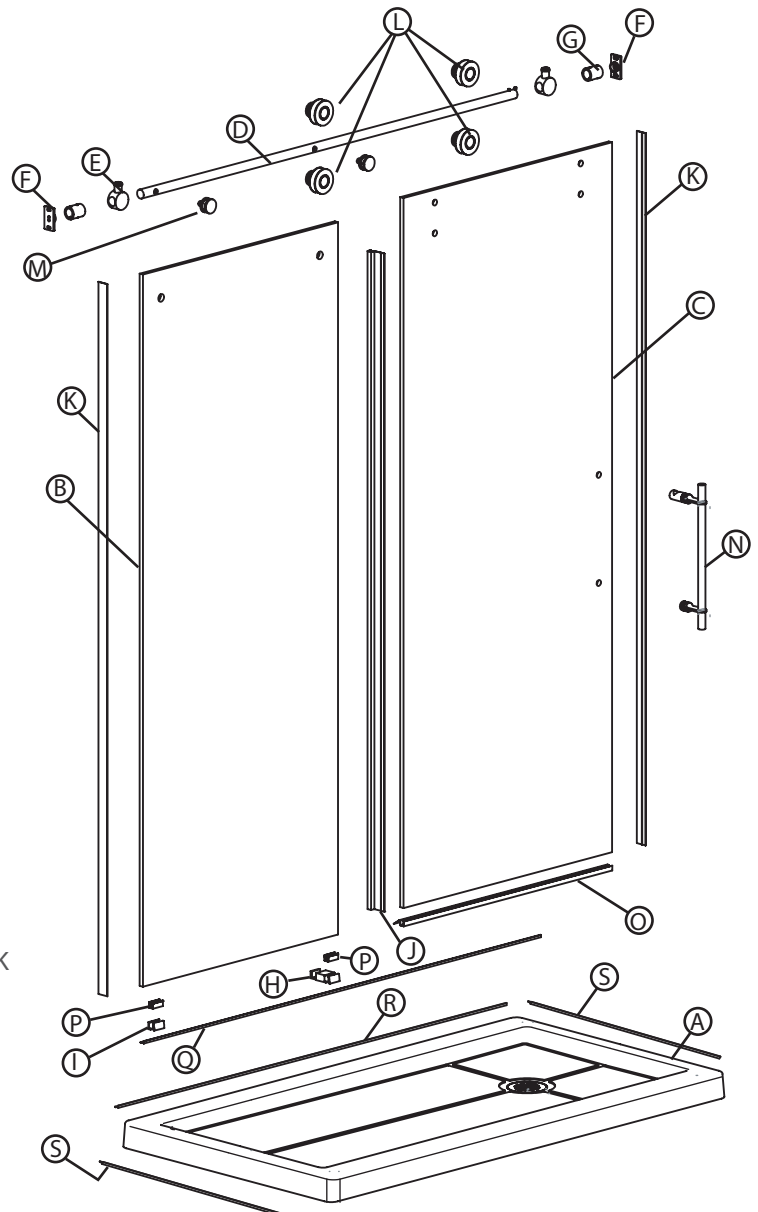

Instructions

The Atlantis shower enclosure is designed to replace a standard 60 by 32 inch (152.4 x 81.3 cm) tub.

The shower enclosure needs to be encased by 3 surrounding walls.

The shower base can be positioned with the drain on the right or left side.

It is recommend the drain be position next to the wall with the shower faucet.

Important : Wall studs will be needed to install the shower enclosure.

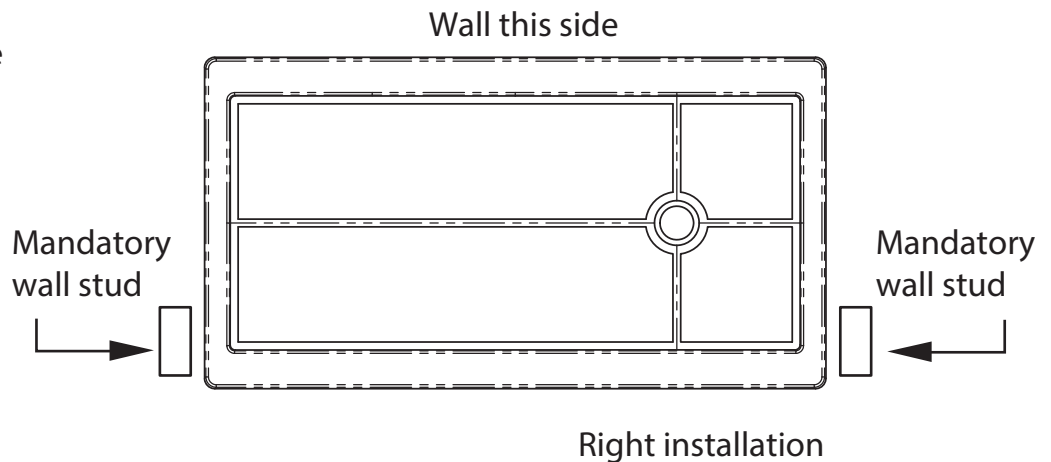

1- Validate dimensions

Verify the distance between the wall studs.

Minimal distance = 60 inches (152.4 cm)

Maximum distance = 60.5 inches (153.8 cm)

2- Test the fit of the shower base

Ensure drainage pipe is centered underneath the shower base drain hole.

The distance between the faucet wall and the center of the drain pipe should be 9.25 inches.

The distance between the 60 inch (152.4 cm) long wall and the drain pipe should be 16 inches.

* If your measurements are different from above, you will need to relocate the position of the drain pipe in the floor. Artika recommends you contact a professional plumber to modify the drain position in the floor.

IMPORTANT

It is recommended that drainage pipes, drains, water lines should all be installed prior to installing the base. Please follow your local building codes.

3- Install the tiling flange

I- Determine the 60 inch (152.4 cm) side of the shower base that will be installed next to the 60 inch wall. This is the side where you will install the long tiling flange.

II- Start with the long tiling flange. The side with the groove in the middle of the flange will face down on the top of the threshold of the shower base.

III- Apply a bead of silicone along the groove.

Use the 1 inch self-drilling screws to install the

IV- tiling flange to the side of the base. Use the bottom groove on the back of the tiling flange as a guide.

Repeat for the 32 inch (81.3 cm) sides of the

V- shower base.

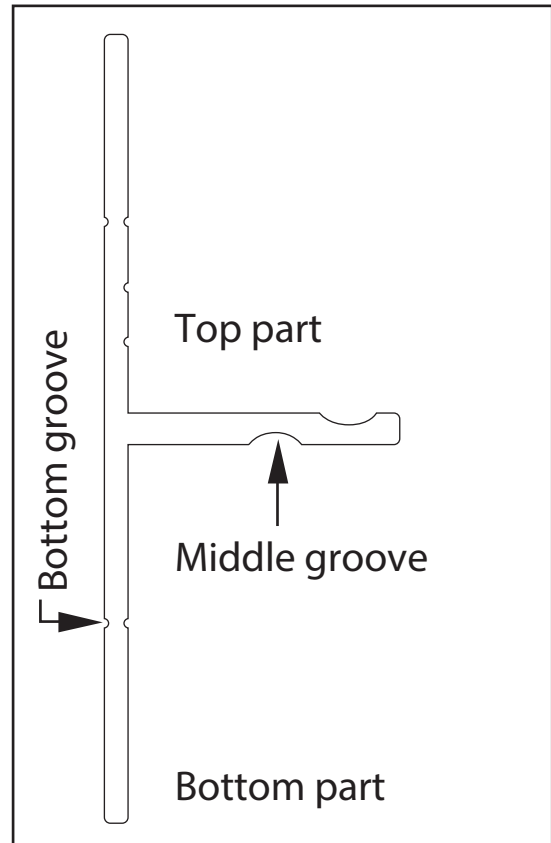

Exploded view

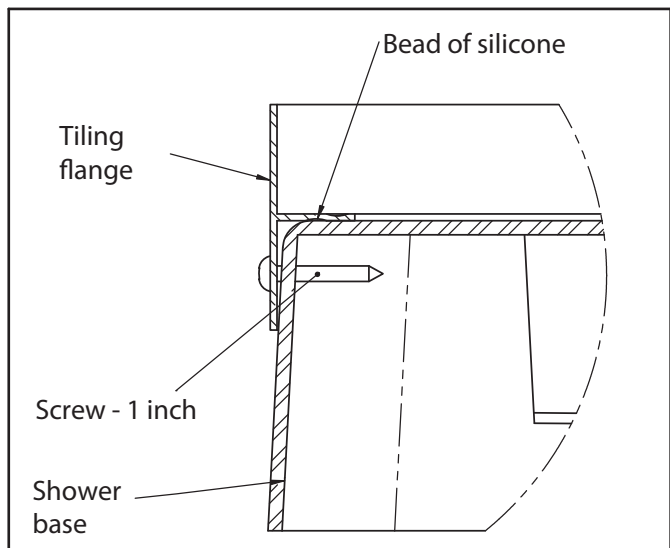
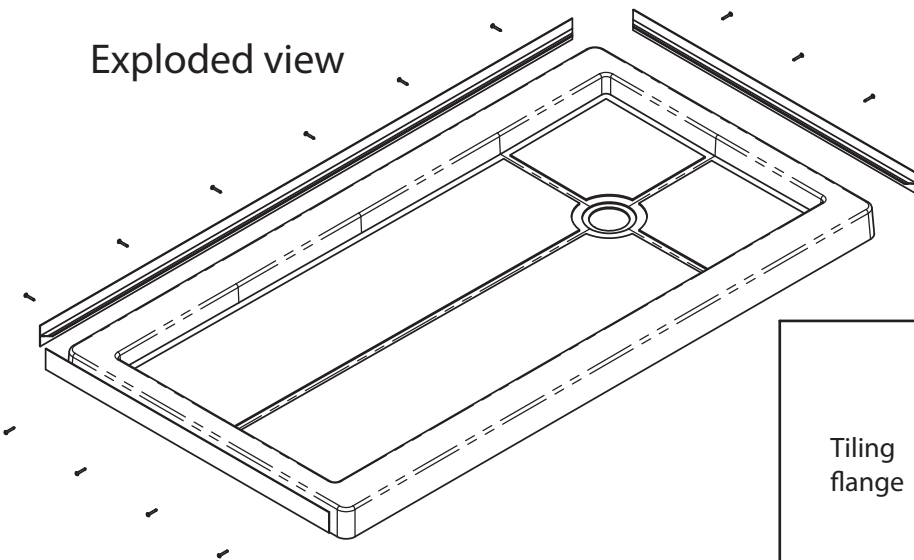

4. Install the drain

- I- Disassemble the drain. Remove the stainless cap, tightening tool, adaptor ring, rubber ring, large nut, cardboard gasket and rubber gasket.
- II- Apply a bead of silicone underneath the drain body and the drain hole on the underside of the drain body and the edge of the drain hole in the shower base.
- III- Insert the drain body in the drain hole.
- IV- Place the rubber gasket, cardboard gasket and then the large nut onto the drain body from underneath the shower base and tighten.
- V- Wipe excess silicone from the drain.
- VI- Place the stainless cap, tightening tool, adaptor ring and the rubber ring in a safe place. They will be installed in a few steps.

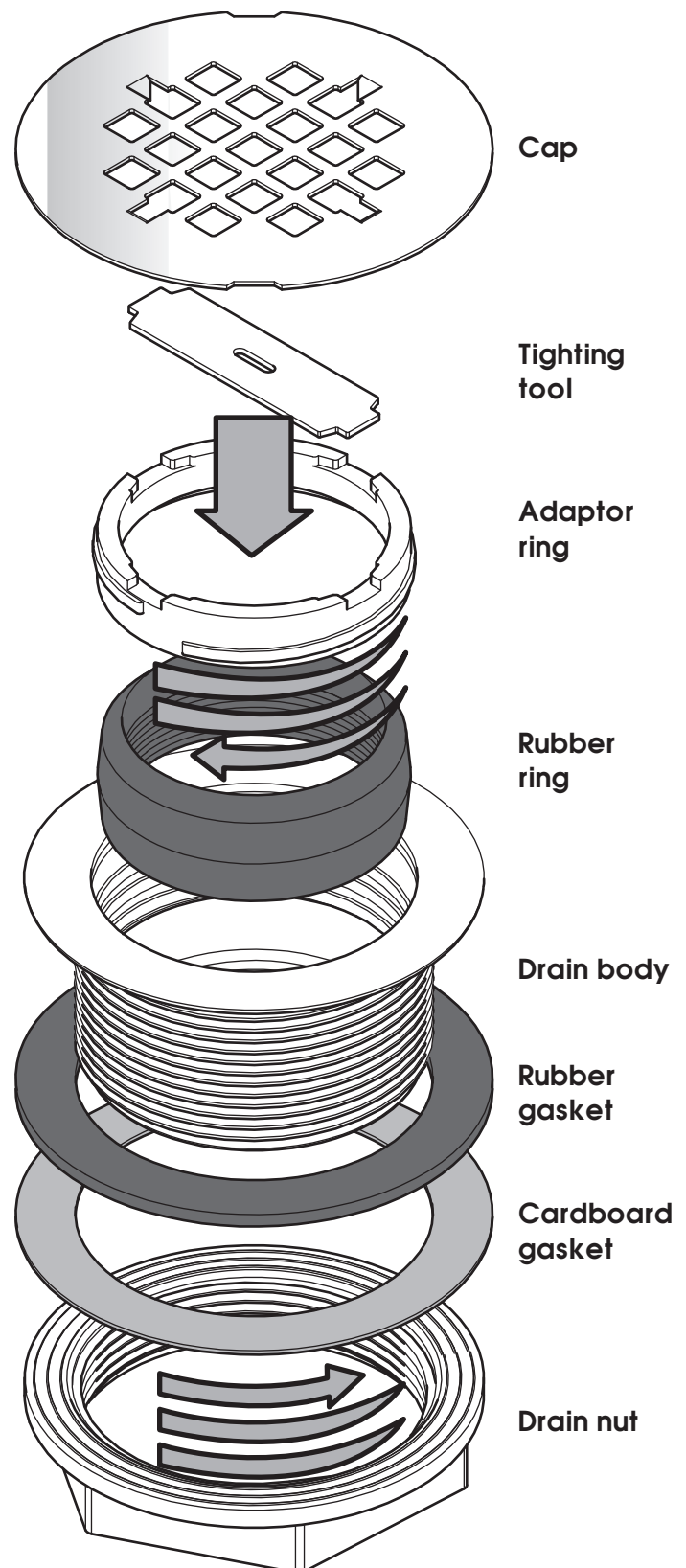
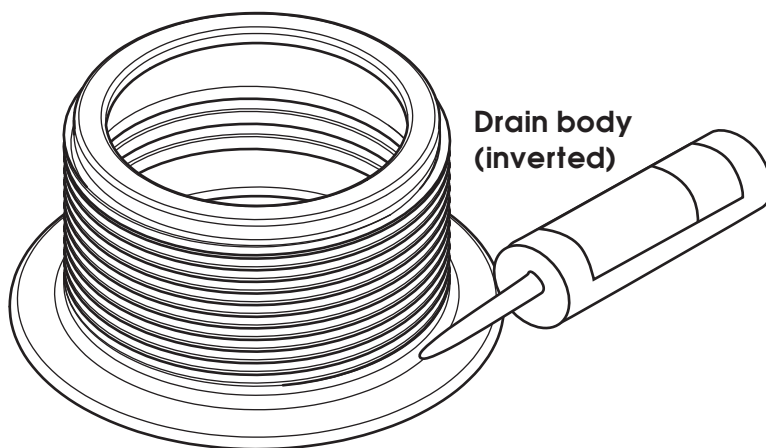

5. Verify the fit of the base

Ensure the base fits properly and the shower base drain hole is centered over the drain hole in the floor.

6. Verify that the base is level

If your base is not level, there are 3 options.

- I- Use wooden shims. Suitable for small adjustments.
- II- Use a leveling compound.
- III- Spreading a mortar.

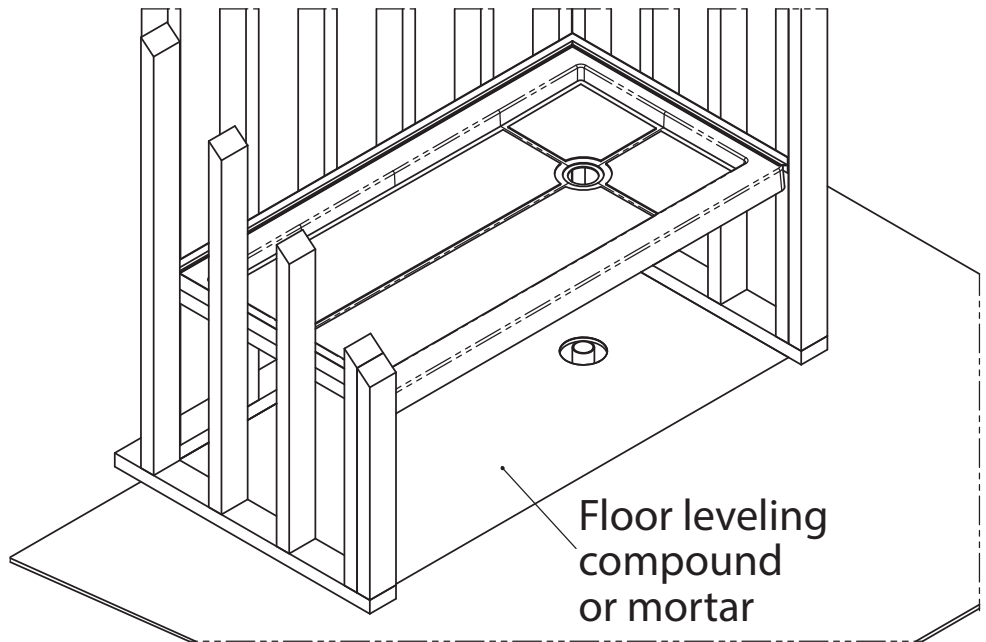

7. Install the base in the shower enclosure

Lower the base into place. Double check to ensure the base is level.

8. Continue installing the drain

- I- Put a rag in the drain pipe.
- II- Insert the rubber ring around the drain pipe.
- III- Insert the adaptor ring around the rubber ring.
- IV- Use the tightening tool to secure the adaptor ring down around the drain.

9. Check for leaks

With the drain still plugged, check for water leaks by filling the shower base with 1 gallon (3.5 liters) of water. Look for air bubbles forming near the drain. If possible, check drainage pipes below the floor for leaks. Remove the rag and the tightening tool. Install the stainless steel drain cover.

10. Secure the tiling flange to the studs

Using the 1.25 inch screws, fasten the tiling flange to each stud. If required use shims to prevent the tiling flange from lifting up from the shower base.

11. Silicone

Apply a bead silicone in each of the two corners where the tiling flanges meet.

12. Install your shower wall material

Install drywall, water proof membrane and tiles. Allow the tiles to fully dry and adhere to the wall (24 hours).

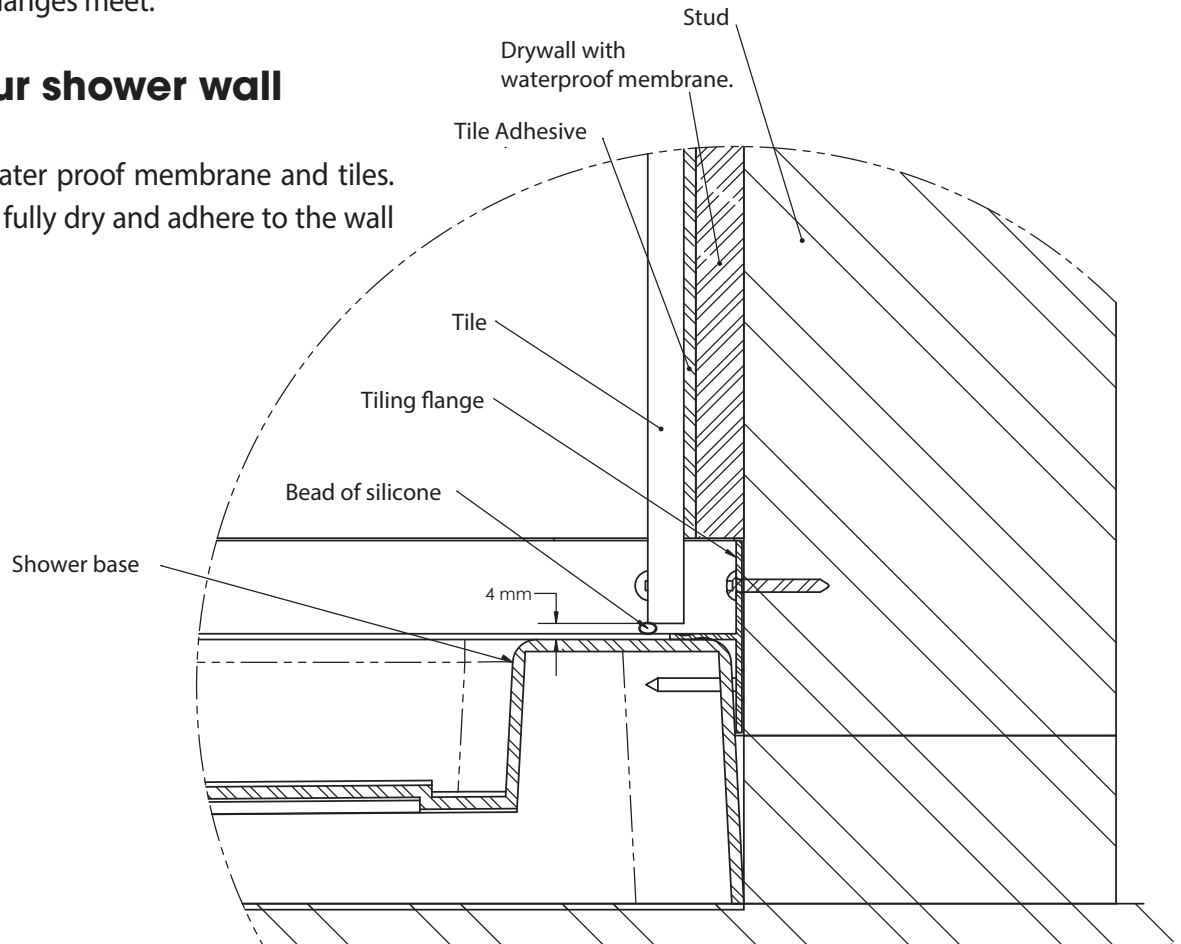

IMPORTANT NOTE

The glass door can be installed on the left or right side.

Artika recommends installing the glass door adjacent to the shower faucet wall.

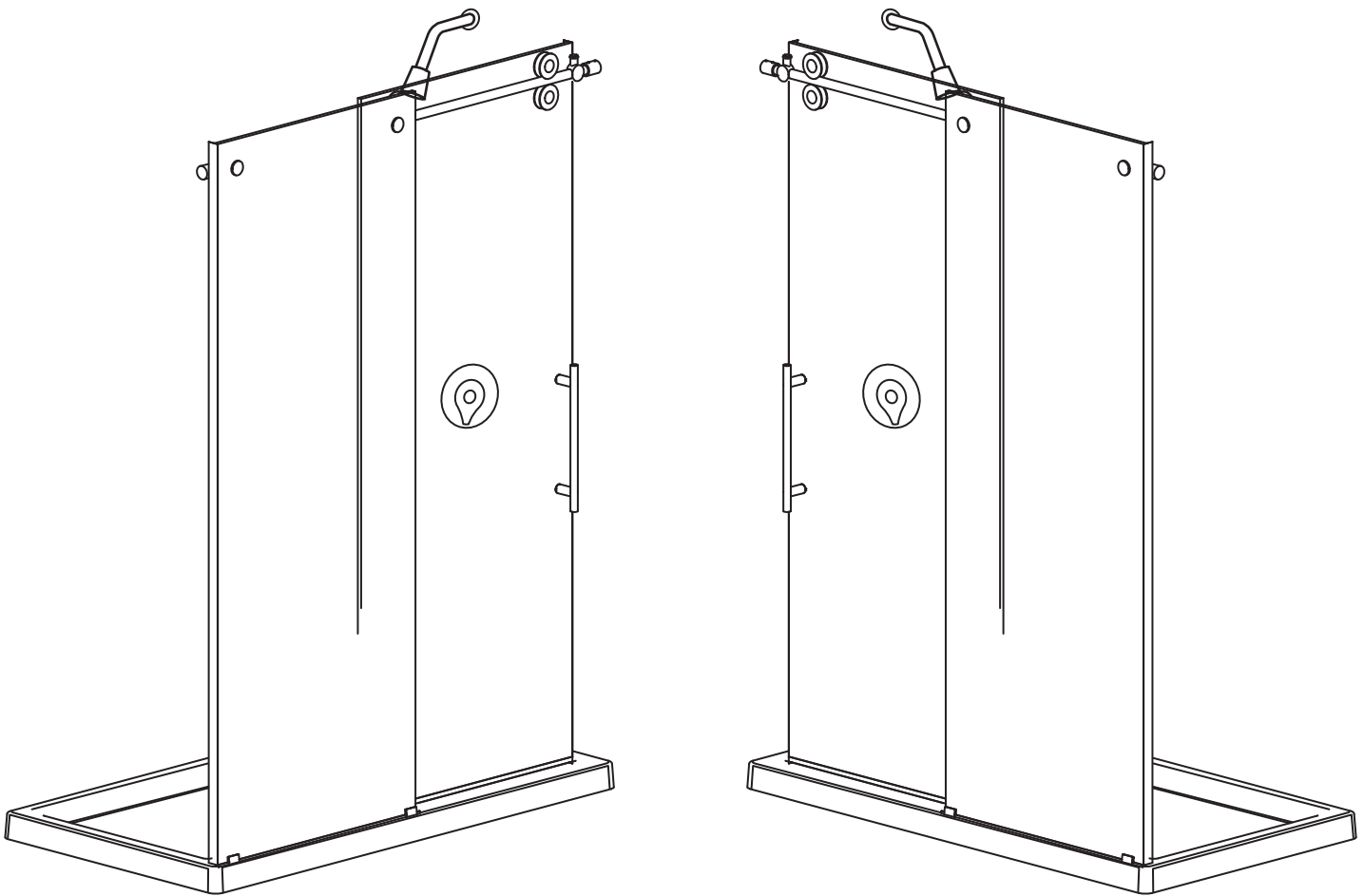

This instruction manual is showing a right side door installation. For a left side door installation, follow the instructions as though the sliding door was on the left.

The sliding door must be on the interior side of the shower.

13. Gaskets placement

*NOTE: Extra gaskets are included. Only one J gasket and two K gaskets are necessary.

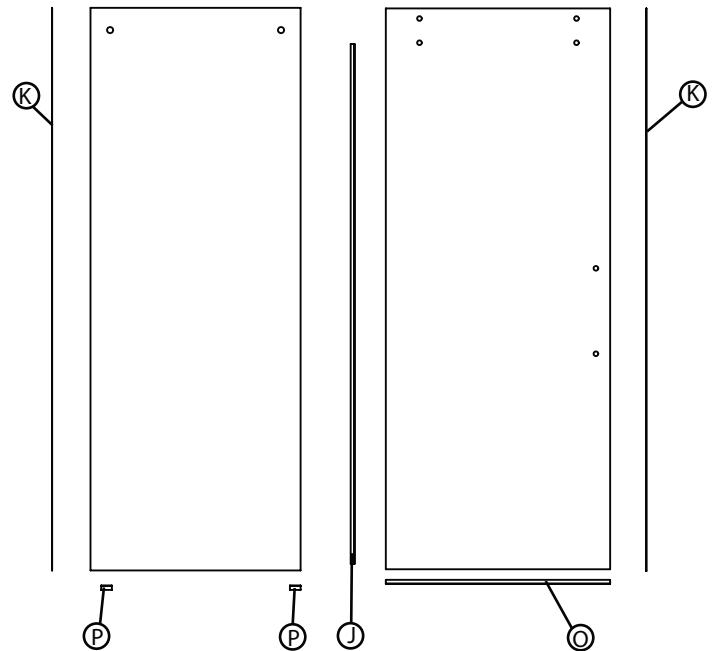

14. Bottom gasket installation

Protect the shower base using a thick piece of cardboard.

Install bottom door gasket O onto the sliding door panel. Make sure the flap is inside the shower.

Place the sliding door panel inside the shower carefully on top of the cardboard.

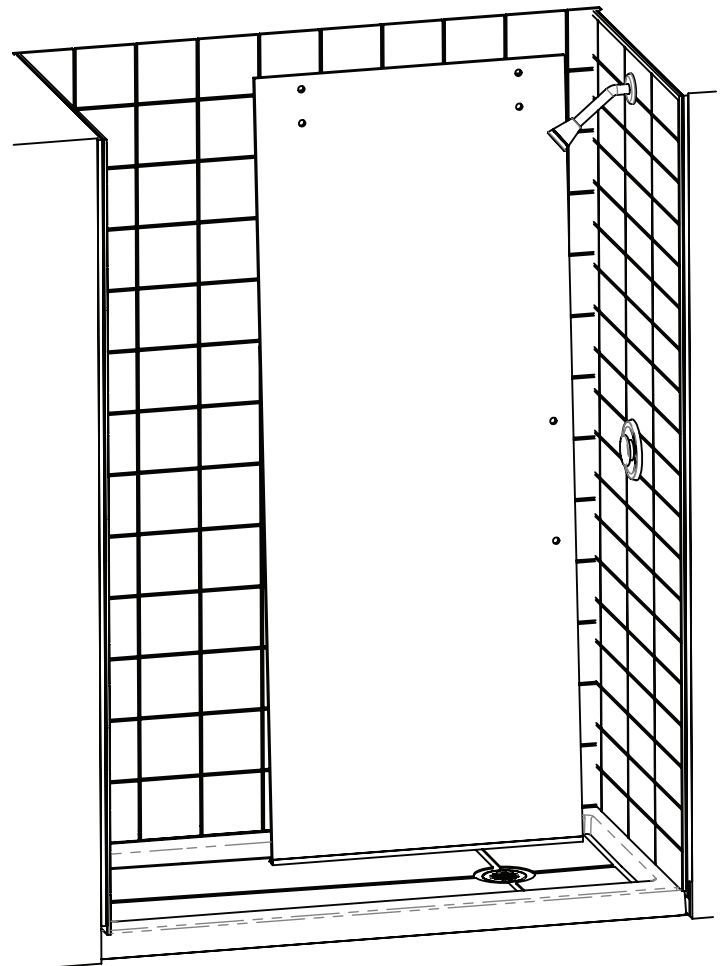
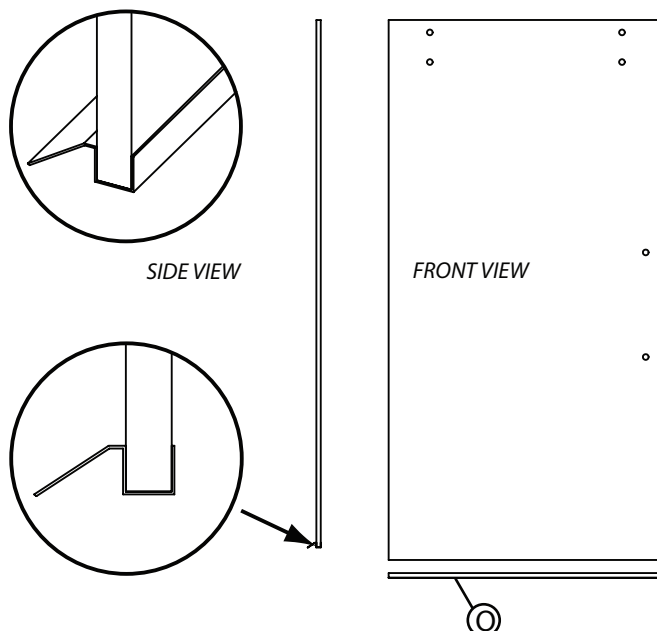

15. Vertical gasket installation

Install one vertical gasket K on the fixed glass panel. The flap goes inside the shower. Install on the side adjacent to the wall.

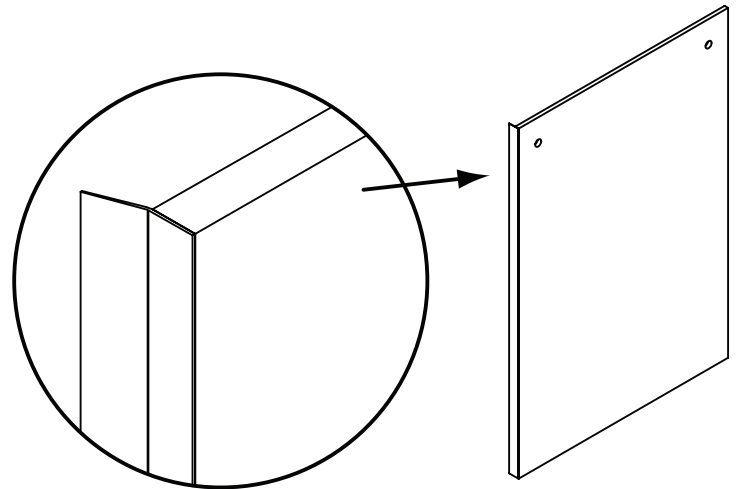

16. Stoppers installation

Put the stoppers on the rail.

Temporarily fix them with the 6 mm Allen key.

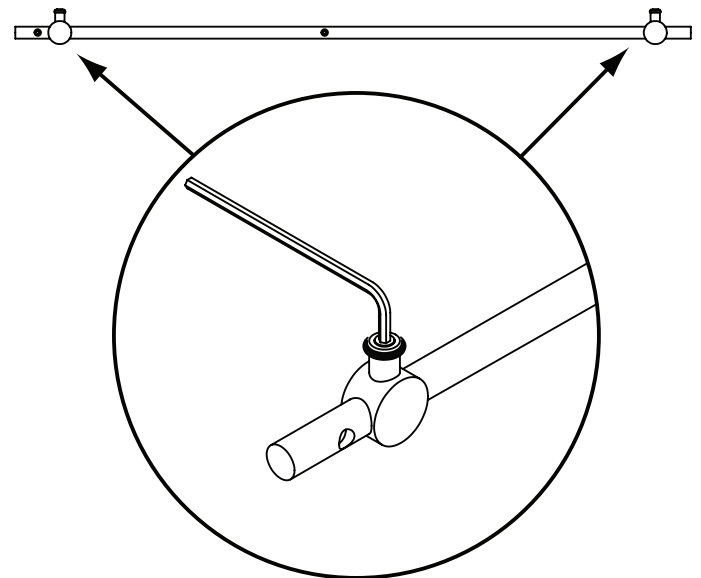

17. Wall brackets installation

Put the wall brackets on the rail.

Temporarily fix them with the 3 mm Allen key.

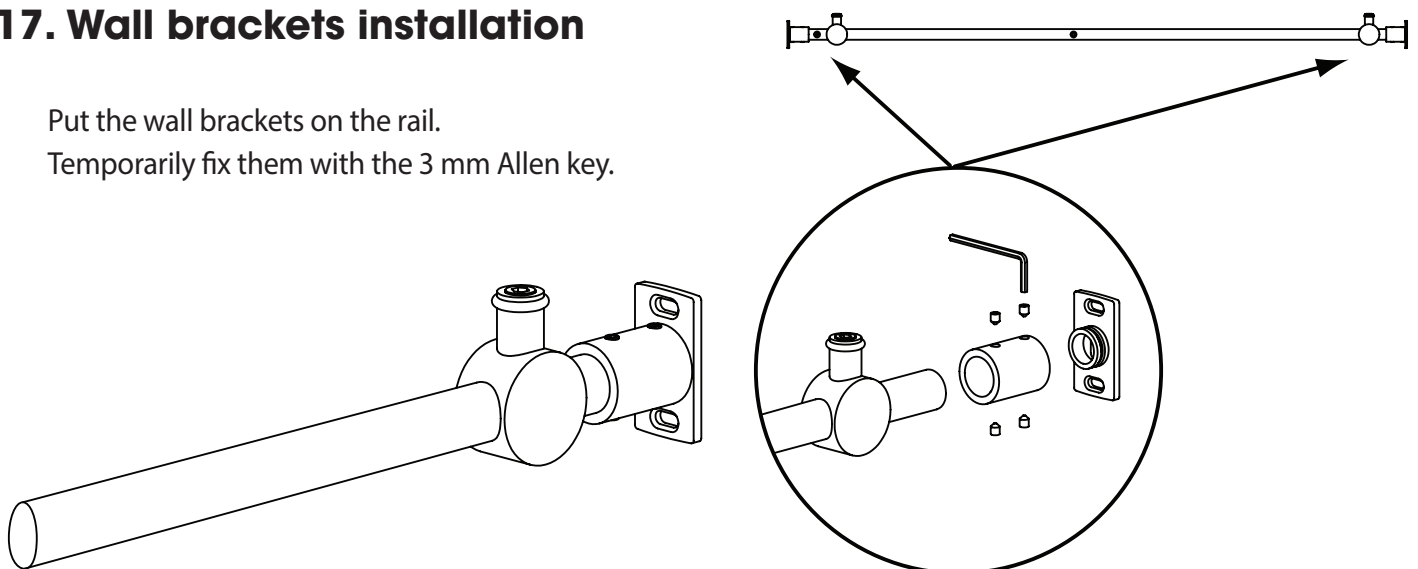

18. Verify the fit of the bar

Insert the bar in the shower. Adjust wall brackets so both ends touch a wall.

Important: Depending on the thickness of tile used, it could be possible that the bar is too long. Artika recommends that you deal with a professional to cut the bar to the right length.

IF NEEDED, CUT THIS END

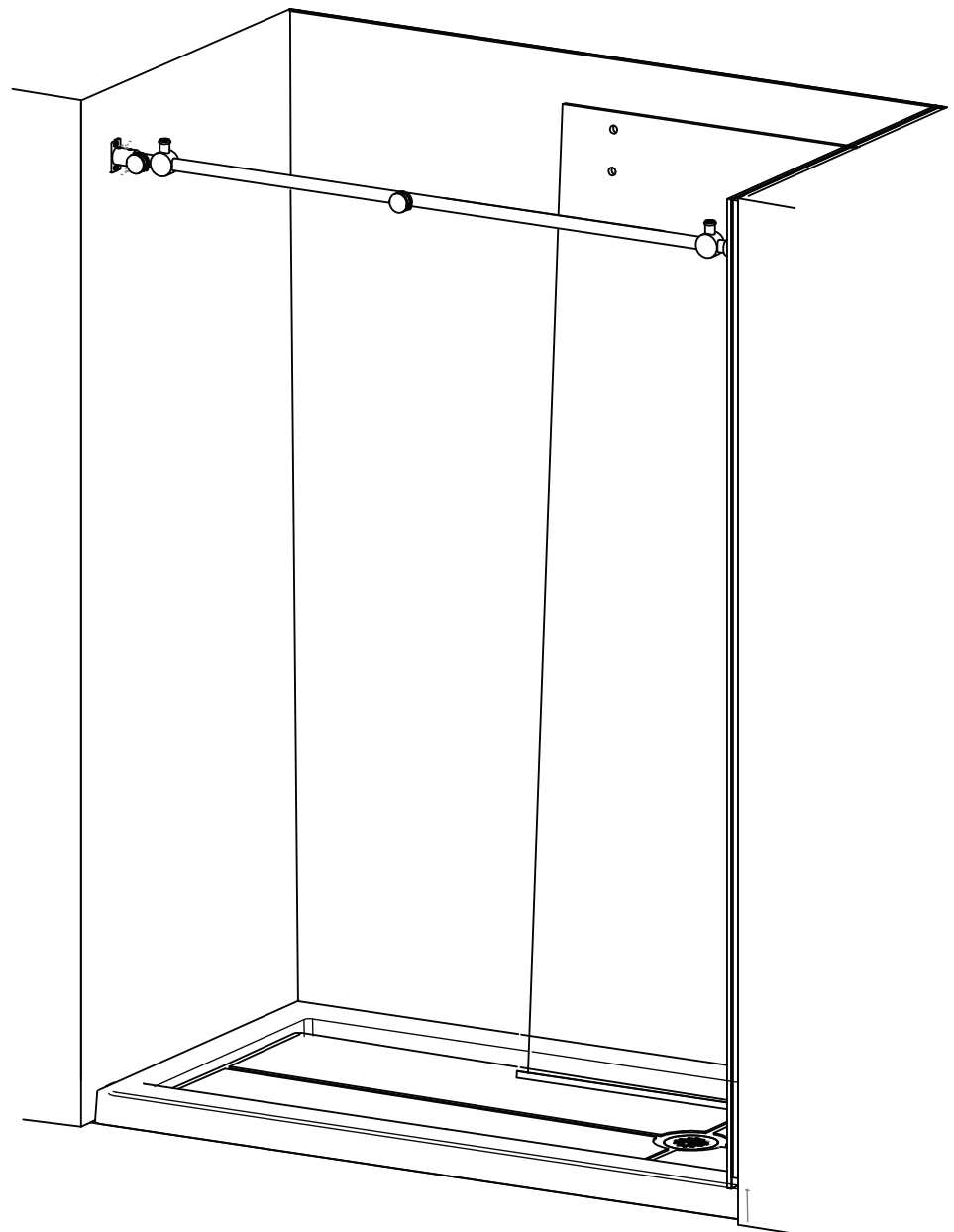

19. Rail installation

Install the rail to the fixed door panel using fixed panel bracket M. Temporarily fix it.

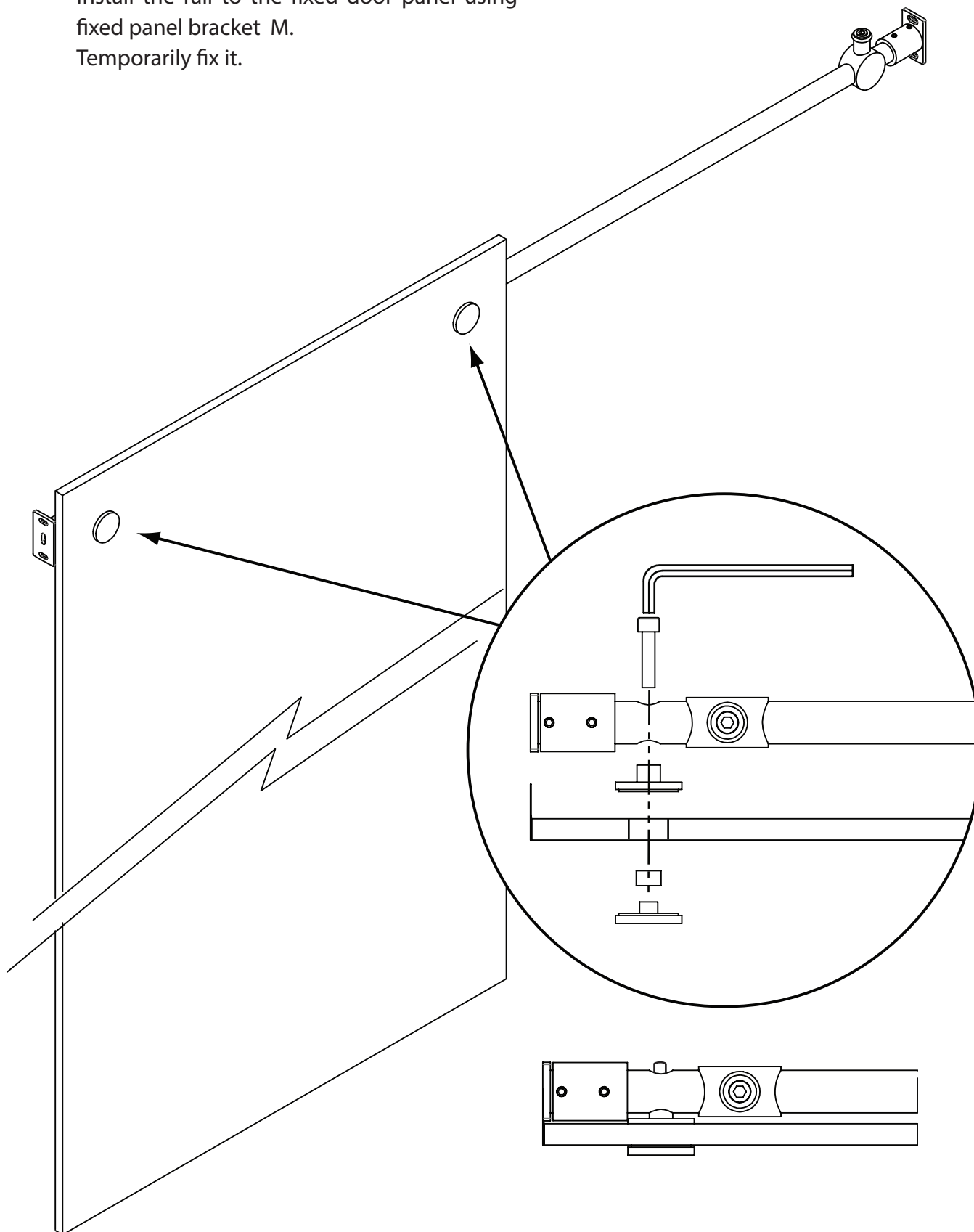

20. Bottom gaskets installation

Place the bottom gaskets P on the fixed panel.
Slide them into the bottom brackets I and H.

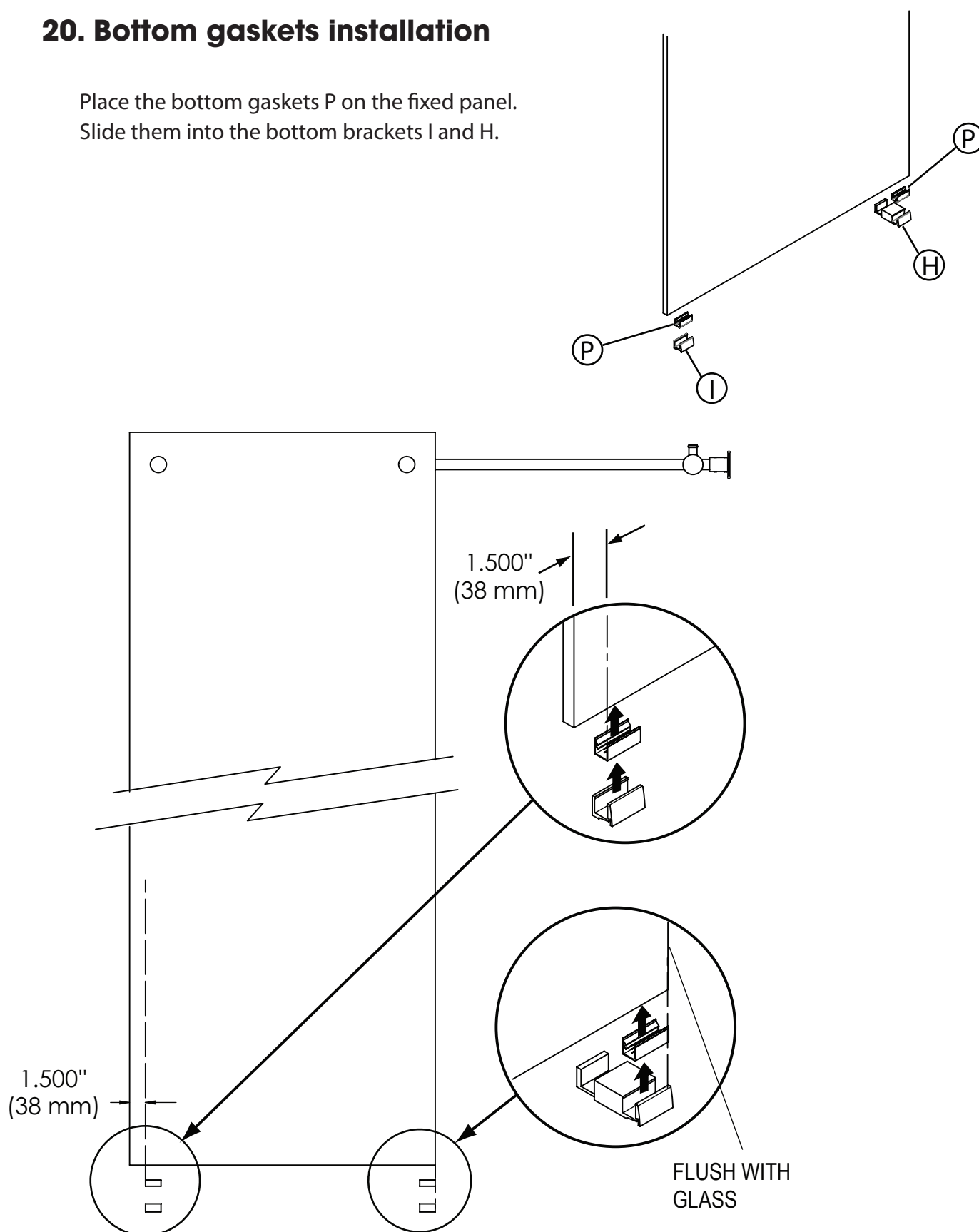

21. Pre installation of the fixed panel.

Two people are required to perform this step. Carefully lift the fixed glass panel in the shower. Verify the rail is leveled. Verify the fixed glass panel is leveled vertically. Verify the fixed glass panel and gasket K are flat against the tiles.

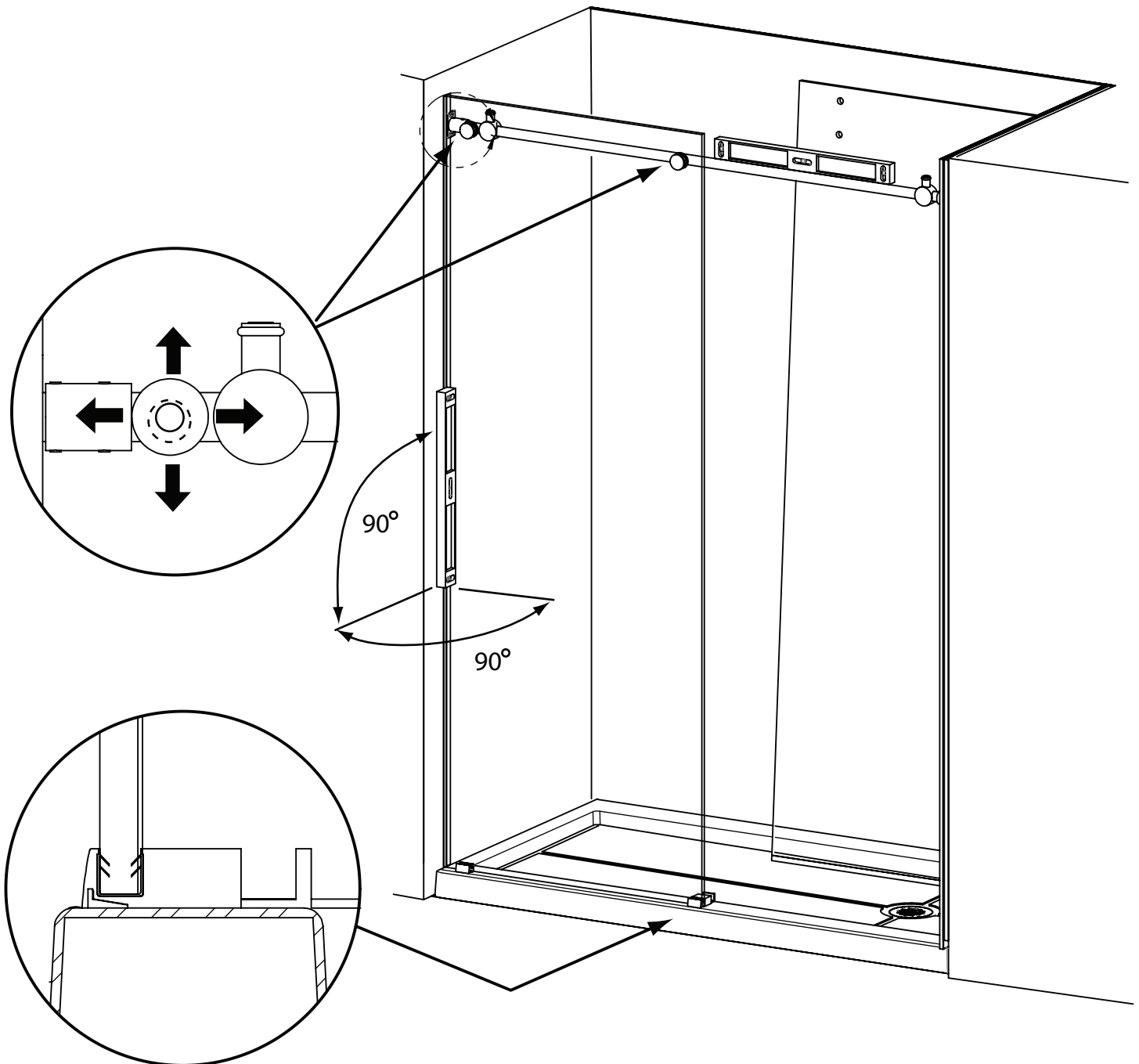

22. Continued

Mark screws locations for the wall brackets.

Important: Wall brackets must be aligning with wall studs.

Mark where bottom brackets I and H will be installed.

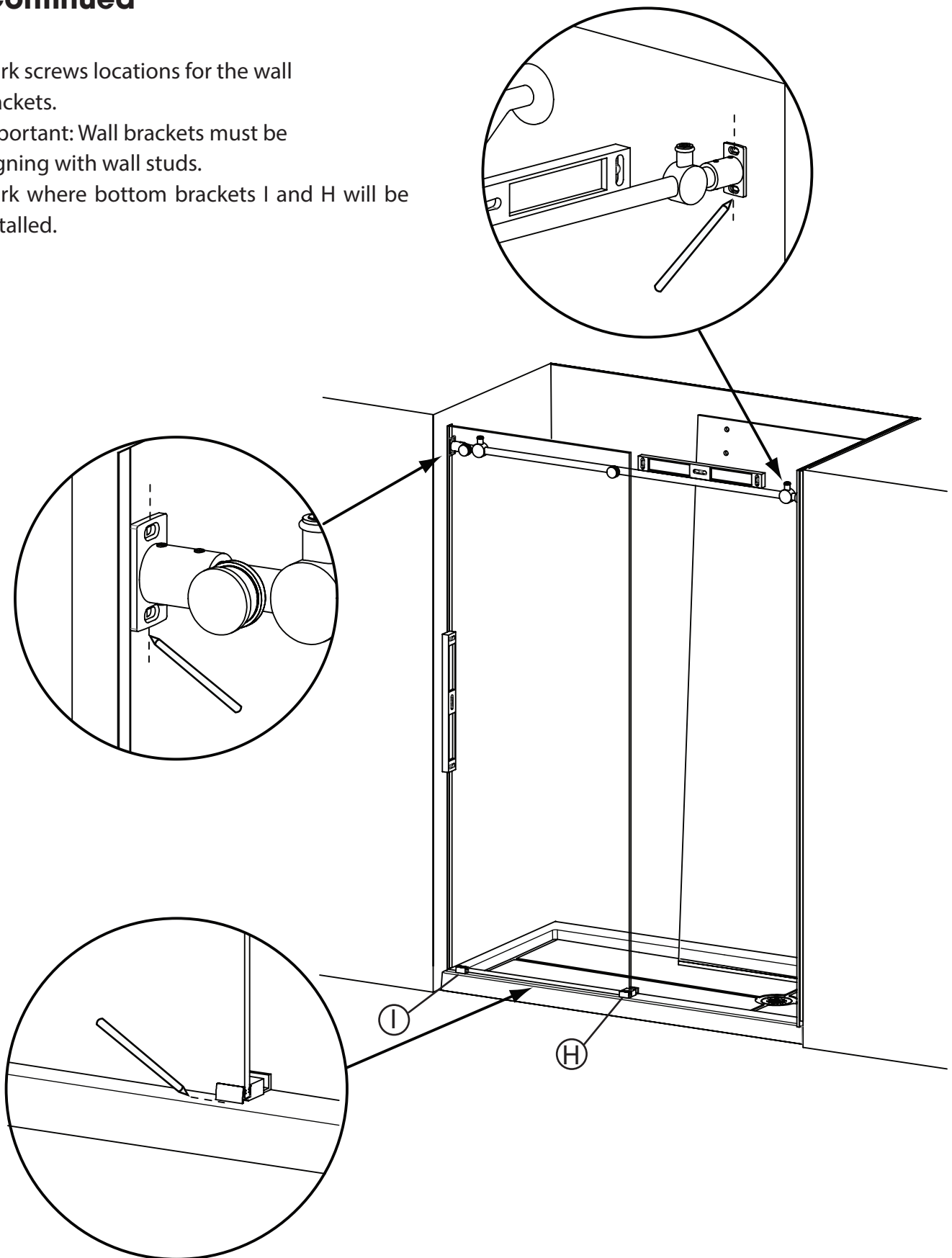

23. Threshold

Remove the fixed door assembly. Verify the threshold fits onto the shower base. If the threshold is too long, use cutting pliers to trim the required length. Apply silicone under the threshold (see below) and position into place. Fix this bottom gaskets over the threshold with the regular screws.

Tip: Before applying the silicone, place the threshold under both brackets and place them on the mark you previously made for the bottom brackets.

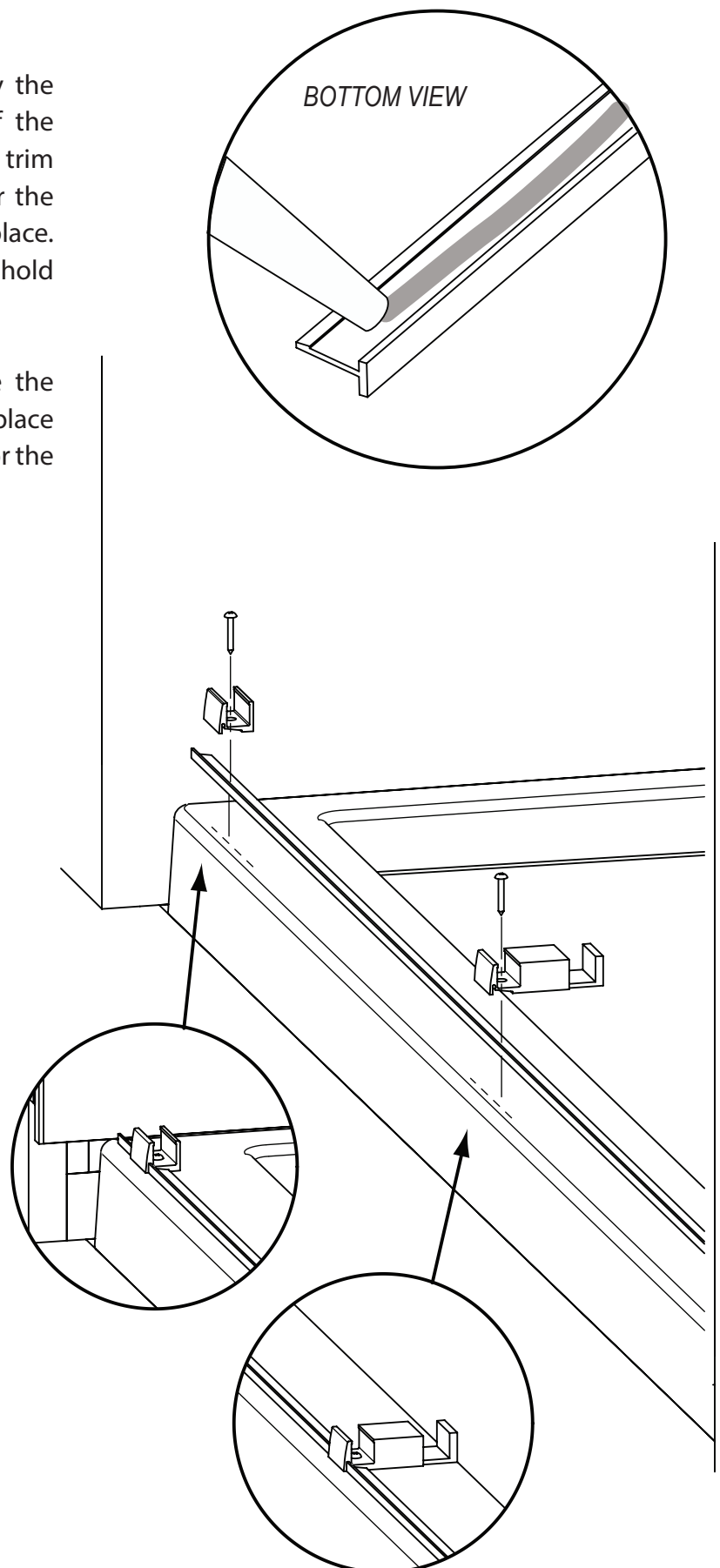

24. Wall brackets installation

Using the pencil mark from step 11, drill two holes on each side.

Use the ceramic drill bit to drill through tiles.
Install wall bracket plates.

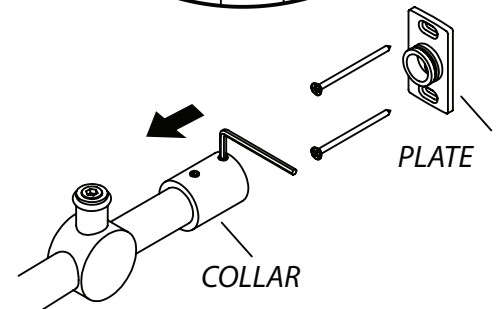
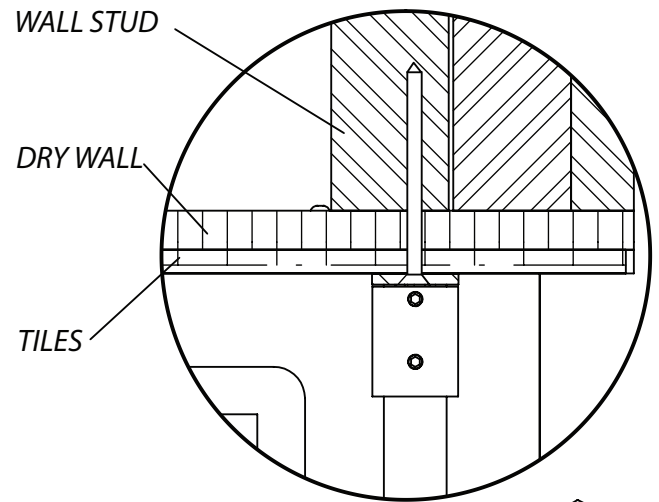

Reinstall the fixed panel assembly.
Slide the collar into place.

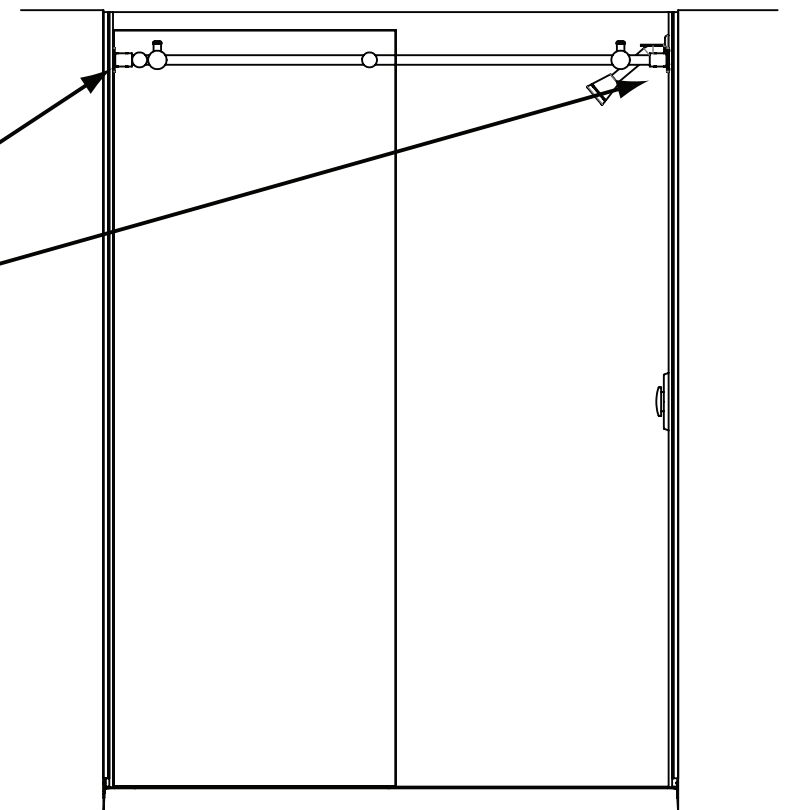
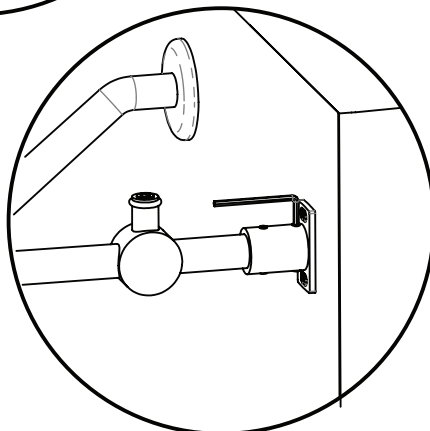
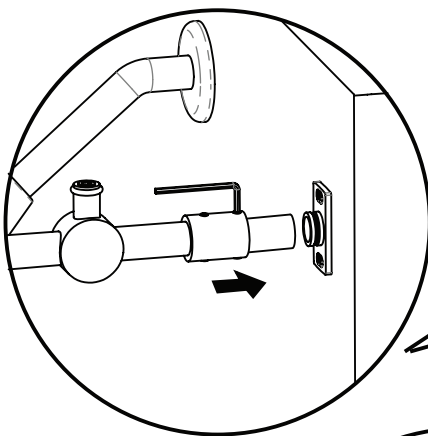

25. Wheels installation

Assemble the two top wheels on the sliding door panel. Wheels have to be installed on the outside of glass door.

Note: At this step, you have to insert the blue dry-adhesive washers to the screw of the wheels before installing on the glass door.

INSIDE VIEW

Two people are required for this step. Carefully lift the shower door into the channel of the double bracket and position the wheels onto the rail simultaneously.

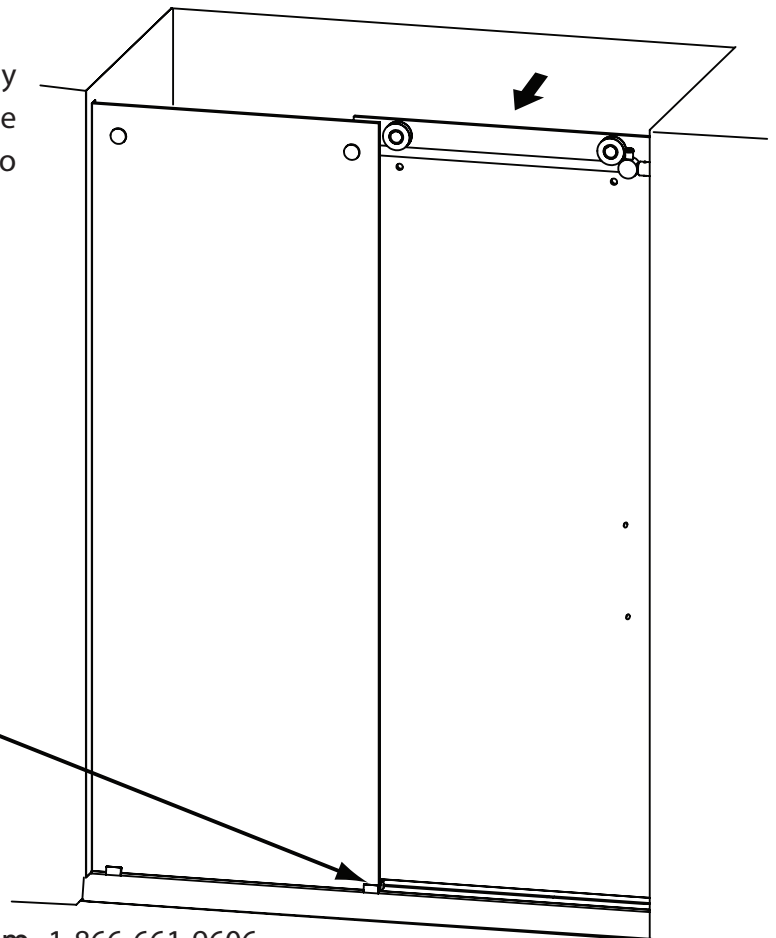
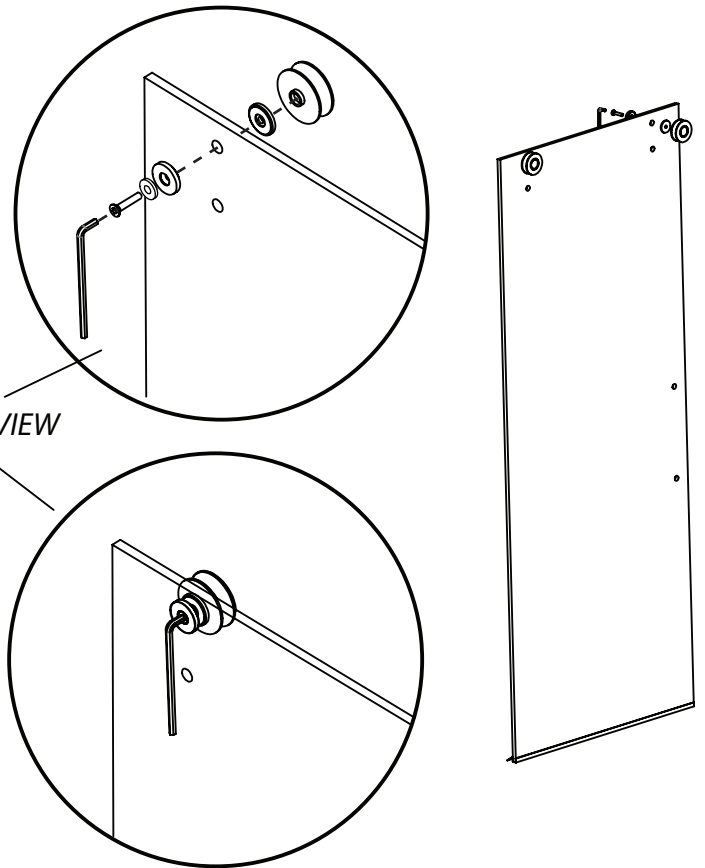
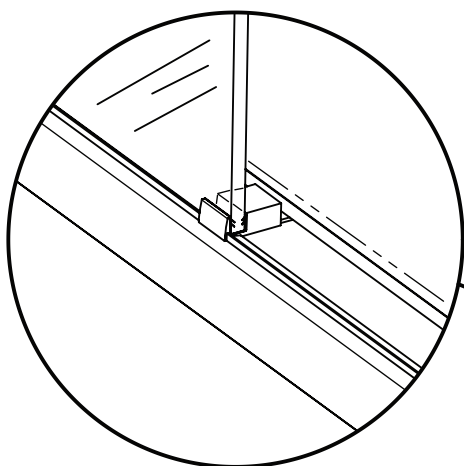

25. Continued

Install the bottom wheels.

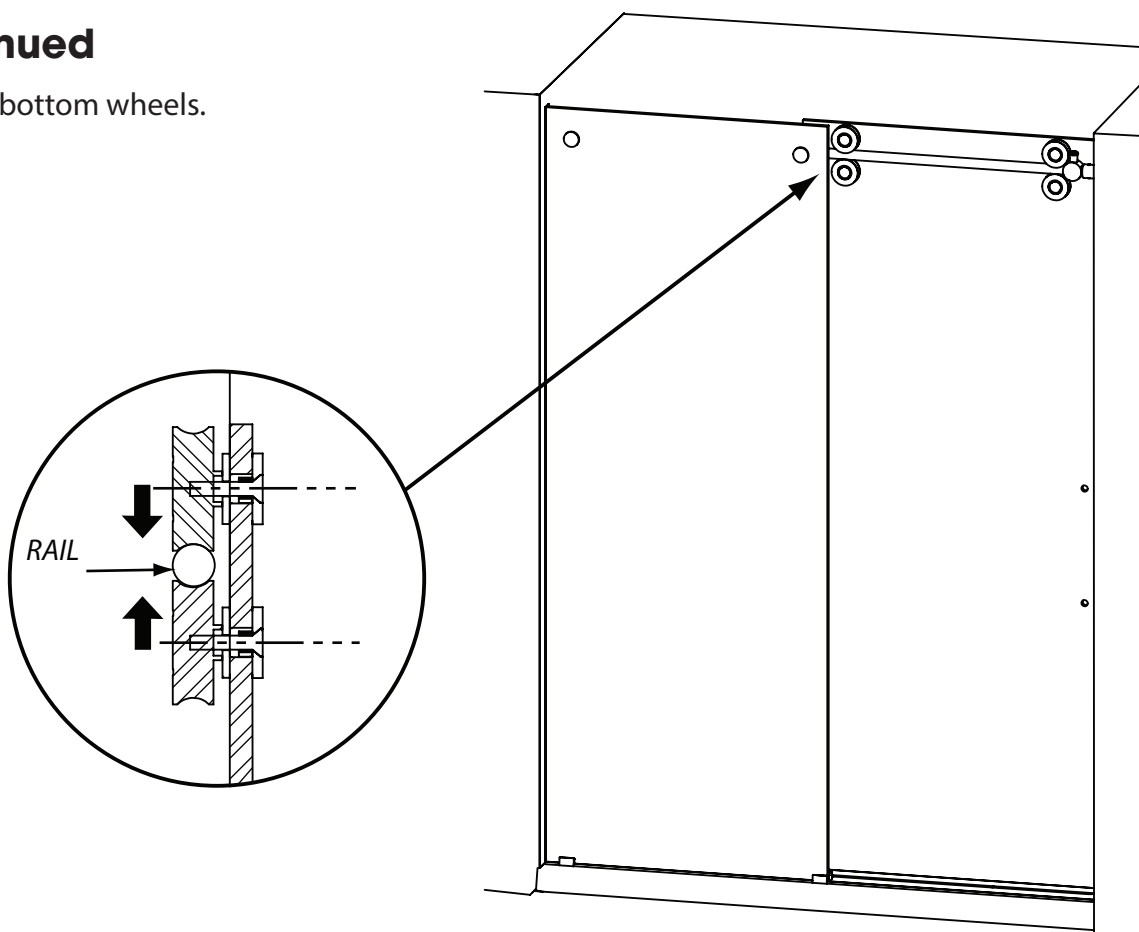

26. Handle installation

Install the handle onto the sliding door panel.

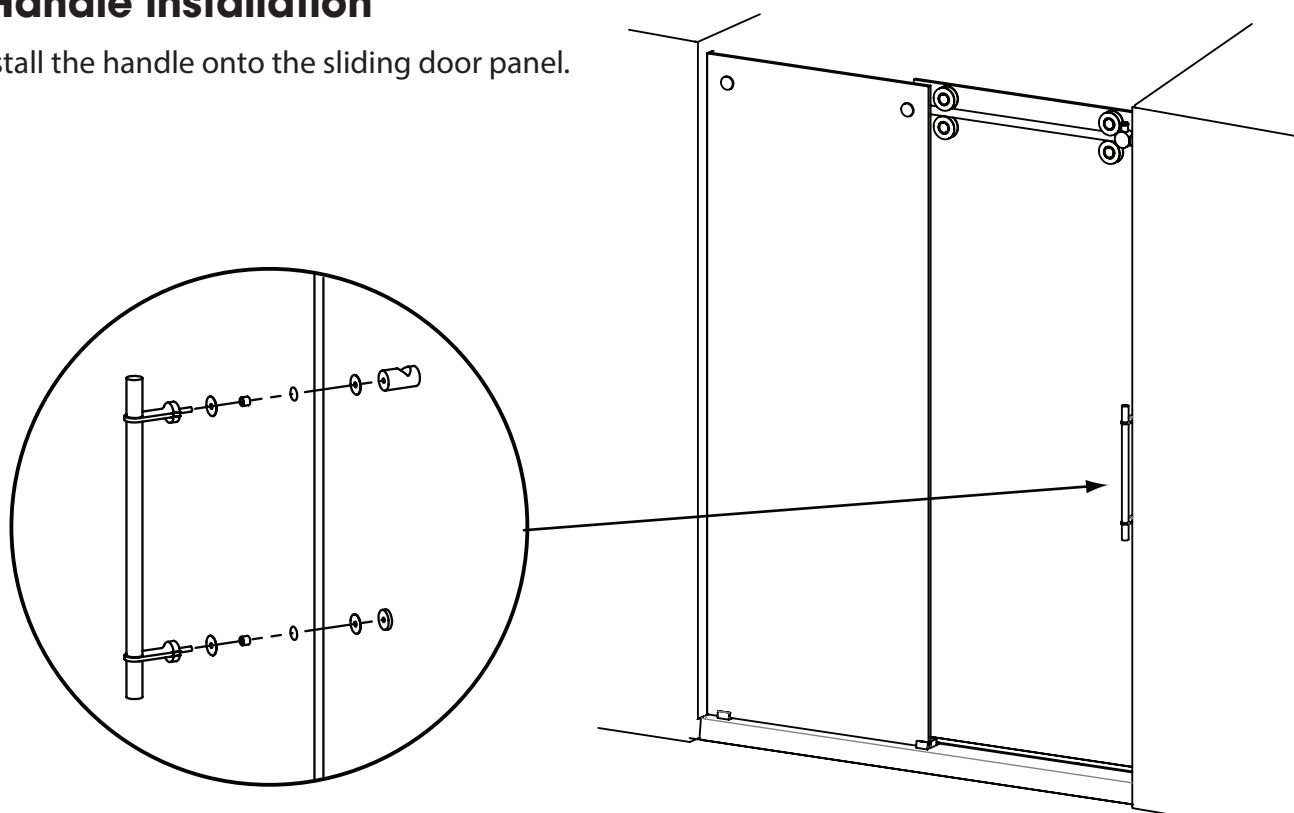

27. Gaskets installation

Install the gasket J onto the sliding door panel. The flap goes between the two panels.

You may cut gasket J to make space for the support bar.

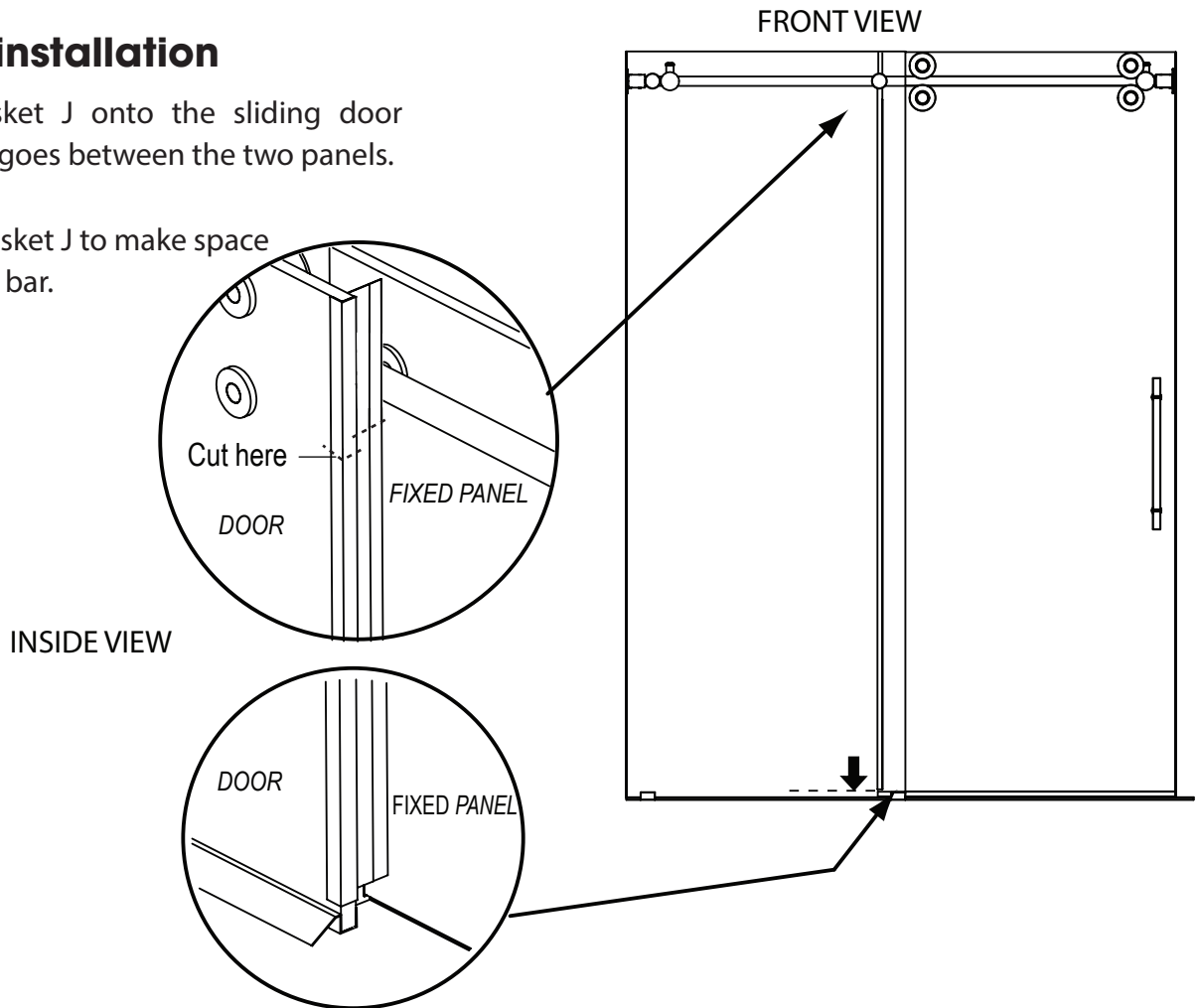

Install the side gasket K onto the sliding door panel. The flap goes inside the shower.

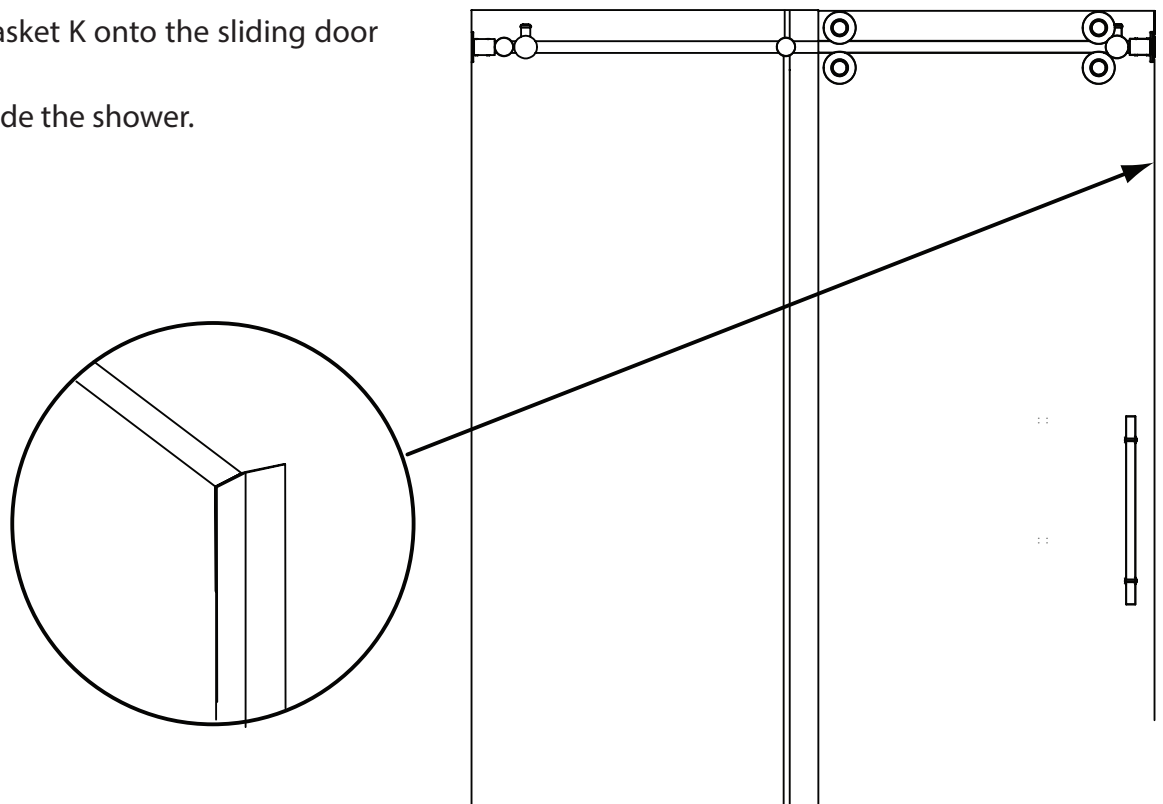

28. Stoppers

Adjust one stopper to ensure the glass door does not hit the wall of the shower. Adjust the other stopper to prevent the handle from coming into contact with the fixed glass panel. Check stoppers are secure.

! Critical Step

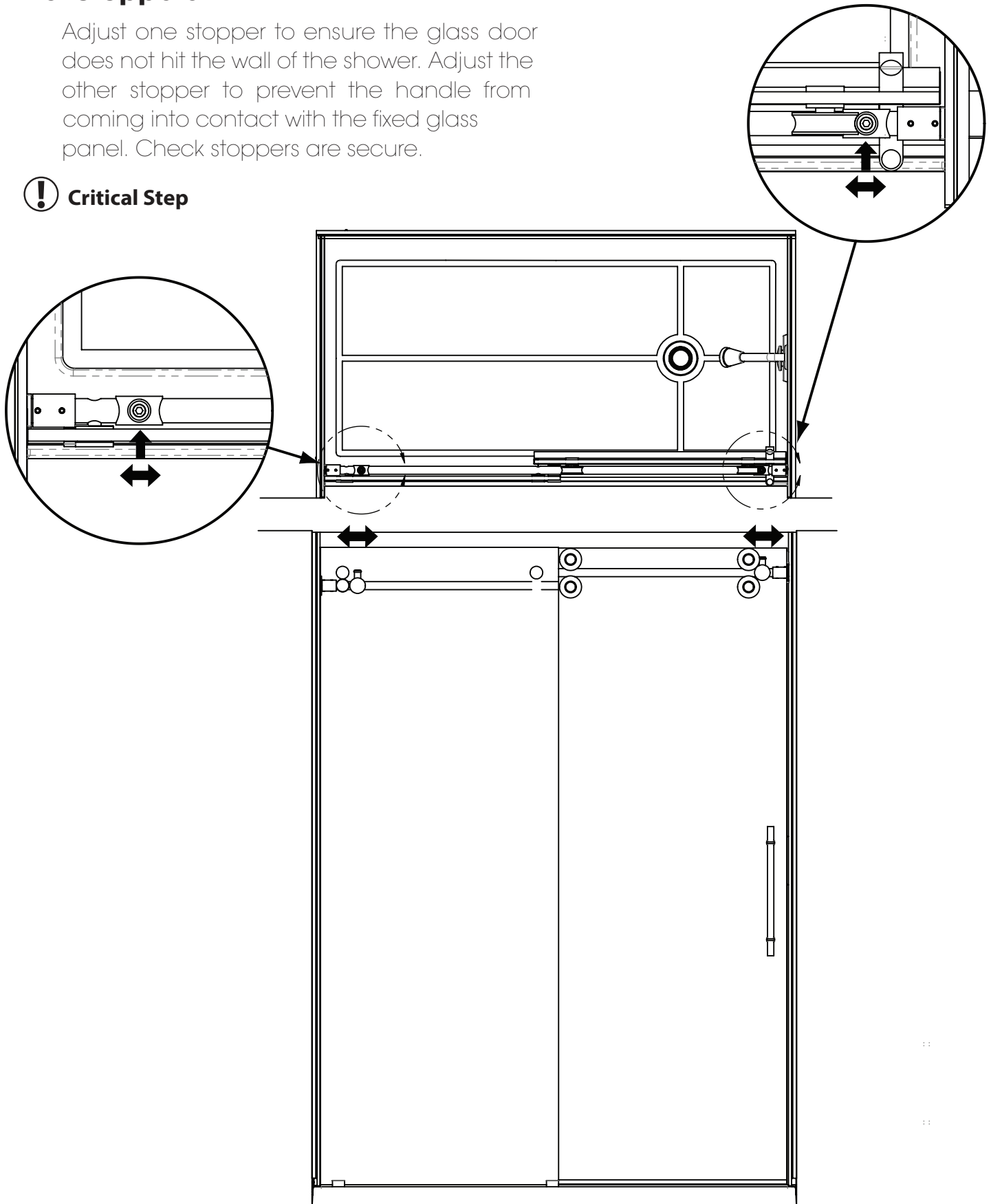

29. Silicone

Apply silicone along the outside edge of the threshold.

Do not shower for 24 hours

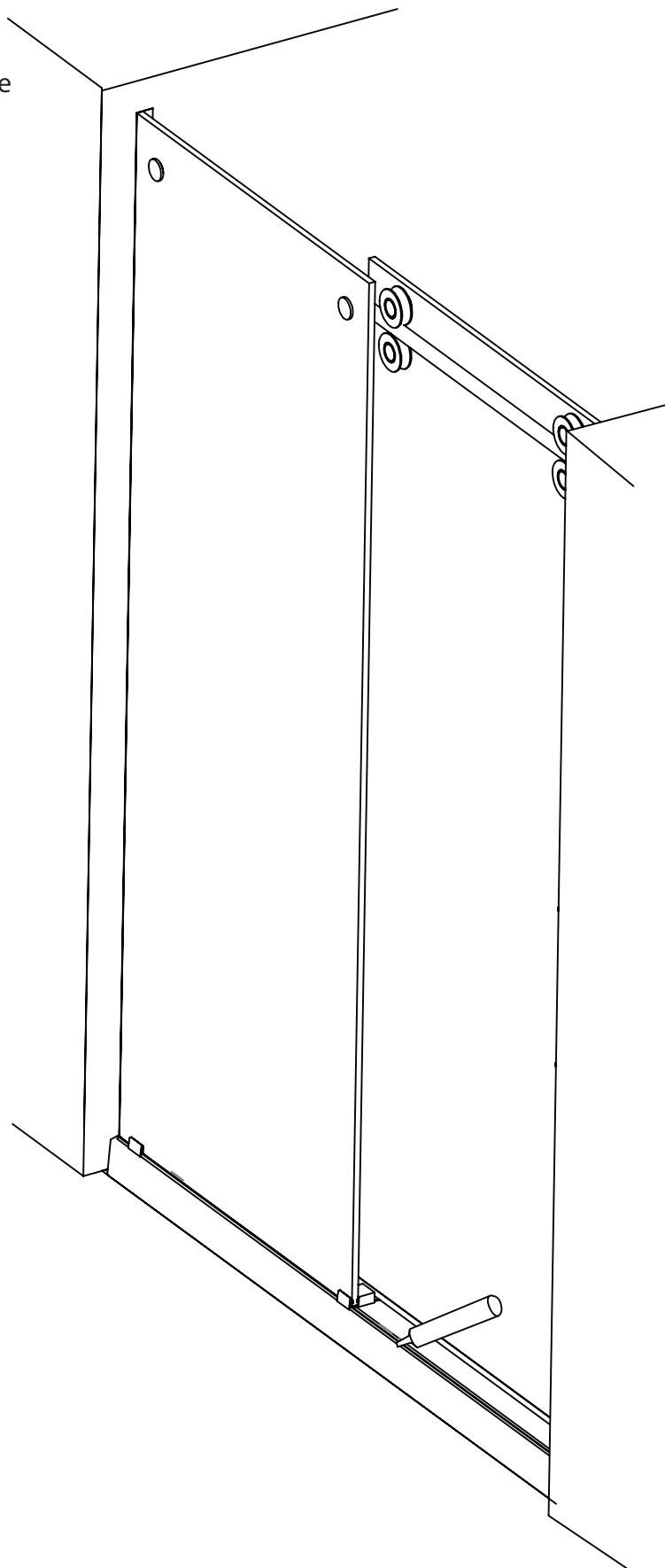
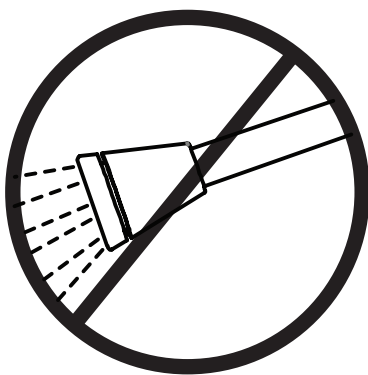

WARRANTY

Artika For Living Inc. is proud to offer you a five (5) year Warranty. We guarantee our product to be free of manufacturing defects in material and workmanship for a period of five (5) years from the date of purchase. Should a defect arise within the warranty period, Artika For Living Inc. will provide replacement product or parts free of charge.

-Our warranty does not cover products installed incorrectly, or subjected to abnormal use. Normal wear and tear, misuse, improper maintenance, alteration of the product or units not installed in accordance to the installation manual will not be covered.

-Our shower enclosure is intended for residential use only. The Warranty does not cover shipping costs, labor costs or any other cost associated with the installation or replacement of the product. The Warranty is extended to the original consumer.

-The amount of the claim cannot exceed the original purchase price of the item. The Warranty does not cover glass breakage.

Artika strongly recommend having the unit installed by professionals in order to avoid glass breakage and, subsequently, injuries. We will not be liable for any defect or breakage that could have been discovered, repaired or avoided prior to installation.

Artika For Living Inc. is not responsible for indirect or consequential damages arising from improper use or installation of this shower unit.

For more information:

1-866-661-9606

customerservice@artikaworld.com